



## IDEAL<sup>®</sup> - BUCHANAN SLK<sup>™</sup> DISCONNECT FUSE KITS



### FEATURES AND BENEFITS

- UL listed for submersible installations when used with boots
- Bright orange for ease of visibility
- Breakaway or non-breakaway
- On Breakaway versions, fuse stays in de-energized load side when disconnected
- In-Line or Y-Tap versions available
- One or two wires on line or load side
- Crimp or set screw wire termination
- Dual (hot/hot) and Paired (hot/neutral) configurations available
- Neutral (i.e., non-fused) versions include dummy fuse
- Rated for copper and aluminum
- Thermoplastic elastomer boots for excellent durability and environmental protection
- Bold, clear markings for easy installation
- Accepts 13/32" x 1 1/2" midget fuses (non-rejection and rejection type)

### SPECIFICATIONS

ELECTRICAL: 30 A, 600 V  
WIRE RANGE: 2 AWG — 14 AWG  
TEMPERATURE: 105°C  
FUSEHOLDER FLAME RATING: 94V-2  
BOOTS: Thermoplastic elastomer  
FUSE HOUSING: Polypropylene  
FUSE CONTACTS: Tin-plated brass  
CRIMP SLEEVES: Tin-plated brass  
SET SCREW LUGS: Tin-plated brass  
FUSE SIZE ACCEPTED: 13/32" x 1 1/2"  
COPPER & ALUMINUM RATED

#### COMPLIANCE:

UL ECIS Special Purpose Connectors, which includes compliance with:

- UL 486A/B (Wire Connector)
- UL 486D (Submersibility)
- UL 498 (Attachment Plugs & Receptacles)
- UL 1682 (Plugs, Receptacles, & Cable Connectors)

Conforms to AASHTO's  
Roadway Lighting Design Guide,  
Chapter 8, October 2005



# IDEAL<sup>®</sup> - BUCHANAN SLK<sup>™</sup> DISCONNECT FUSE KITS

**CONFIGURATION EXAMPLES**  
Some illustrations enlarged to show detail  
Not all configurations shown

**DIMENSIONS**  
(Images not to scale)



CRIMP FUSEHOLDER



SET SCREW FUSEHOLDER



IN-LINE FUSED  
(ONE WIRE LINE/LOAD)



IN-LINE NEUTRAL  
(ONE WIRE LINE/LOAD)



Y-TAP  
(TWO WIRE LINE, ONE WIRE LOAD)



Y-TAP  
(TWO WIRE LINE/LOAD)



DUAL  
(ONE WIRE LINE/LOAD)



PAIRED  
(ONE WIRE LINE/LOAD)

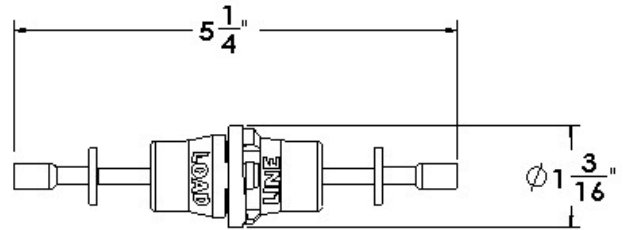

CRIMP FUSEHOLDER

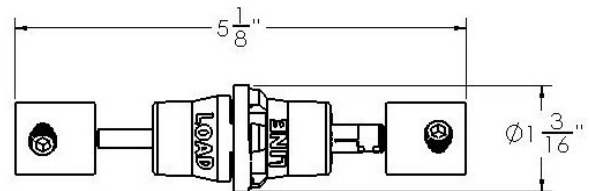

SET SCREW FUSEHOLDER

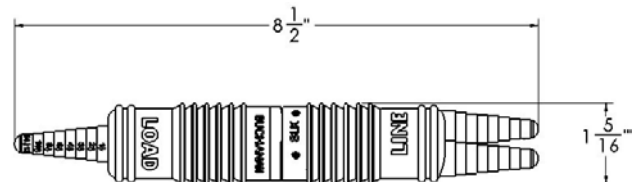

IN-LINE AND Y-TAP

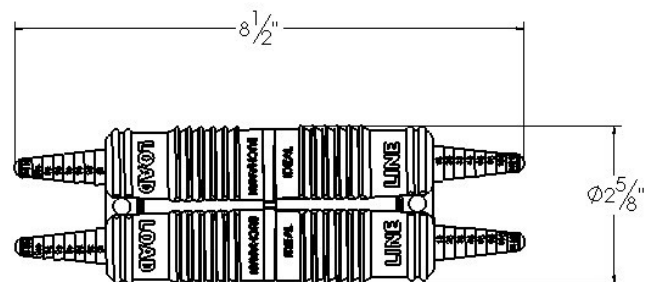

DUAL AND PAIRED

Note: Neutral versions utilize a white fuseholder and include a dummy fuse.



# IDEAL<sup>®</sup> - BUCHANAN SLK<sup>™</sup> DISCONNECT FUSE KITS

## ORDERING INFORMATION

### TO DETERMINE WHICH KIT TO USE:

1. Select the base part number, based on crimp termination (TABLE 1) or set screw termination (TABLE 2), number of wires on line/load side, and wire size.
2. If necessary, modify the base part number according to neutral, dual, paired, or non-breakaway configurations. Use TABLE 3 for crimp variations and TABLE 4 for set screw variations.
3. For examples, see the bottom of this page.

Note: For fuseholder-only or combination (set screw line side, crimp load side) applications, please see the bottom of the table on the next page.

**TABLE 1:  
CRIMP BASE  
PART NUMBERS**

|      |        | Load   |          |          |          |          |          |          |          |          |       |          |          |          |          |          |          |
|------|--------|--------|----------|----------|----------|----------|----------|----------|----------|----------|-------|----------|----------|----------|----------|----------|----------|
|      |        | 1 Wire |          |          |          |          |          | 2 Wire   |          |          |       |          |          |          |          |          |          |
|      |        | 2 AWG  | 4 AWG    | 6 AWG    | 8 AWG    | 10 AWG   | 12 AWG   | 14 AWG   | 2 AWG    | 4 AWG    | 6 AWG | 8 AWG    | 10 AWG   | 12 AWG   | 14 AWG   |          |          |
| Line | 1 Wire | 2 AWG  | 30-C1212 | 30-C1212 | 30-C1216 | 30-C1216 | 30-C1216 | 30-C1216 | 30-C1216 | 30-C1216 |       |          | 30-C1222 | 30-C1222 | 30-C1226 | 30-C1226 | 30-C1226 |
|      |        | 4 AWG  |          | 30-C1212 | 30-C1216 | 30-C1216 | 30-C1216 | 30-C1216 | 30-C1216 |          |       | 30-C1222 | 30-C1222 | 30-C1226 | 30-C1226 | 30-C1226 | 30-C1226 |
|      |        | 6 AWG  |          |          | 30-C1616 | 30-C1616 | 30-C1616 | 30-C1616 | 30-C1616 |          |       | 30-C1622 | 30-C1622 | 30-C1626 | 30-C1626 | 30-C1626 | 30-C1626 |
|      |        | 8 AWG  |          |          |          | 30-C1616 | 30-C1616 | 30-C1616 | 30-C1616 |          |       |          | 30-C1622 | 30-C1626 | 30-C1626 | 30-C1626 | 30-C1626 |
|      |        | 10 AWG |          |          |          |          | 30-C1616 | 30-C1616 | 30-C1616 |          |       |          |          | 30-C1626 | 30-C1626 | 30-C1626 | 30-C1626 |
|      |        | 12 AWG |          |          |          |          |          | 30-C1616 | 30-C1616 |          |       |          |          |          | 30-C1626 | 30-C1626 | 30-C1626 |
|      | 14 AWG |        |          |          |          |          |          | 30-C1616 |          |          |       |          |          |          |          | 30-C1626 |          |
|      | 2 Wire | 2 AWG  | 30-C2012 | 30-C2012 | 30-C2016 | 30-C2016 | 30-C2016 | 30-C2016 | 30-C2016 | 30-C2016 |       |          | 30-C2022 | 30-C2022 | 30-C2026 | 30-C2026 | 30-C2026 |
|      |        | 4 AWG  |          | 30-C2012 | 30-C2016 | 30-C2016 | 30-C2016 | 30-C2016 | 30-C2016 |          |       | 30-C2022 | 30-C2022 | 30-C2026 | 30-C2026 | 30-C2026 | 30-C2026 |
|      |        | 6 AWG  |          |          | 30-C2216 | 30-C2216 | 30-C2216 | 30-C2216 | 30-C2216 |          |       | 30-C2222 | 30-C2222 | 30-C2226 | 30-C2226 | 30-C2226 | 30-C2226 |
|      |        | 8 AWG  |          |          |          | 30-C2216 | 30-C2216 | 30-C2216 | 30-C2216 |          |       |          | 30-C2222 | 30-C2226 | 30-C2226 | 30-C2226 | 30-C2226 |
|      |        | 10 AWG |          |          |          |          | 30-C2616 | 30-C2616 | 30-C2616 |          |       |          |          | 30-C2626 | 30-C2626 | 30-C2626 | 30-C2626 |
|      |        | 12 AWG |          |          |          |          |          | 30-C2616 | 30-C2616 |          |       |          |          |          | 30-C2626 | 30-C2626 | 30-C2626 |
|      | 14 AWG |        |          |          |          |          |          | 30-C2616 |          |          |       |          |          |          |          | 30-C2626 |          |

**TABLE 2:  
SET SCREW BASE  
PART NUMBERS**

|      |        | Load   |          |          |          |          |          |          |          |          |          |          |          |          |          |          |
|------|--------|--------|----------|----------|----------|----------|----------|----------|----------|----------|----------|----------|----------|----------|----------|----------|
|      |        | 1 Wire |          |          |          |          |          | 2 Wire   |          |          |          |          |          |          |          |          |
|      |        | 2 AWG  | 4 AWG    | 6 AWG    | 8 AWG    | 10 AWG   | 12 AWG   | 14 AWG   | 2 AWG    | 4 AWG    | 6 AWG    | 8 AWG    | 10 AWG   | 12 AWG   | 14 AWG   |          |
| Line | 1 Wire | 2 AWG  | 30-S1212 | 30-S1212 | 30-S1212 | 30-S1212 | 30-S1212 | 30-S1212 | 30-S1212 | 30-S1212 | 30-S1212 | 30-S1212 | 30-S1212 | 30-S1212 | 30-S1212 | 30-S1212 |
|      |        | 4 AWG  |          | 30-S1212 | 30-S1212 | 30-S1212 | 30-S1212 | 30-S1212 | 30-S1212 |          | 30-S1222 | 30-S1222 | 30-S1222 | 30-S1222 | 30-S1222 | 30-S1222 |
|      |        | 6 AWG  |          |          | 30-S1212 | 30-S1212 | 30-S1212 | 30-S1212 | 30-S1212 |          |          | 30-S1222 | 30-S1222 | 30-S1222 | 30-S1222 | 30-S1222 |
|      |        | 8 AWG  |          |          |          | 30-S1212 | 30-S1212 | 30-S1212 | 30-S1212 |          |          |          | 30-S1222 | 30-S1222 | 30-S1222 | 30-S1222 |
|      |        | 10 AWG |          |          |          |          | 30-S1212 | 30-S1212 | 30-S1212 |          |          |          |          | 30-S1222 | 30-S1222 | 30-S1222 |
|      |        | 12 AWG |          |          |          |          |          | 30-S1212 | 30-S1212 |          |          |          |          |          | 30-S1222 | 30-S1222 |
|      | 14 AWG |        |          |          |          |          |          | 30-S1212 |          |          |          |          |          |          | 30-S1222 |          |
|      | 2 Wire | 2 AWG  | 30-S2212 | 30-S2212 | 30-S2212 | 30-S2212 | 30-S2212 | 30-S2212 | 30-S2212 | 30-S2212 | 30-S2212 | 30-S2212 | 30-S2212 | 30-S2212 | 30-S2212 | 30-S2212 |
|      |        | 4 AWG  |          | 30-S2212 | 30-S2212 | 30-S2212 | 30-S2212 | 30-S2212 | 30-S2212 |          | 30-S2222 | 30-S2222 | 30-S2222 | 30-S2222 | 30-S2222 | 30-S2222 |
|      |        | 6 AWG  |          |          | 30-S2212 | 30-S2212 | 30-S2212 | 30-S2212 | 30-S2212 |          |          | 30-S2222 | 30-S2222 | 30-S2222 | 30-S2222 | 30-S2222 |
|      |        | 8 AWG  |          |          |          | 30-S2212 | 30-S2212 | 30-S2212 | 30-S2212 |          |          |          | 30-S2222 | 30-S2222 | 30-S2222 | 30-S2222 |
|      |        | 10 AWG |          |          |          |          | 30-S2212 | 30-S2212 | 30-S2212 |          |          |          |          | 30-S2222 | 30-S2222 | 30-S2222 |
|      |        | 12 AWG |          |          |          |          |          | 30-S2212 | 30-S2212 |          |          |          |          |          | 30-S2222 | 30-S2222 |
|      | 14 AWG |        |          |          |          |          |          | 30-S2212 |          |          |          |          |          |          | 30-S2222 |          |

**TABLE 3: CRIMP VARIATIONS**

| BASE PART NUMBER<br>(Hot) | VARIATION (IF APPLICABLE) |           |           |               |
|---------------------------|---------------------------|-----------|-----------|---------------|
|                           | Neutral                   | Dual      | Paired    | Non-Breakaway |
| 30-C1212                  | 30-C1212N                 | 30-C1212D | 30-C1212P |               |
| 30-C1216                  | 30-C1216N                 | 30-C1216D | 30-C1216P |               |
| 30-C1616                  | 30-C1616N                 | 30-C1616D | 30-C1616P |               |
| 30-C1222                  | 30-C1222N                 |           |           |               |
| 30-C1226                  | 30-C1226N                 |           |           |               |
| 30-C1622                  | 30-C1622N                 |           |           |               |
| 30-C1626                  | 30-C1626N                 |           |           |               |
| 30-C2012                  | 30-C2012N                 |           |           | 30-C2012T     |
| 30-C2016                  | 30-C2016N                 |           |           | 30-C2016T     |
| 30-C2216                  | 30-C2216N                 |           |           | 30-C2216T     |
| 30-C2616                  | 30-C2616N                 |           |           | 30-C2616T     |
| 30-C2022                  | 30-C2022N                 | 30-C2022D | 30-C2022P |               |
| 30-C2026                  | 30-C2026N                 | 30-C2026D | 30-C2026P |               |
| 30-C2222                  | 30-C2222N                 | 30-C2222D | 30-C2222P |               |
| 30-C2226                  | 30-C2226N                 | 30-C2226D | 30-C2226P |               |
| 30-C2626                  | 30-C2626N                 | 30-C2626D | 30-C2626P |               |

**TABLE 4: SET SCREW VARIATIONS**

| BASE PART NUMBER<br>(Hot) | VARIATION (IF APPLICABLE) |           |           |               |
|---------------------------|---------------------------|-----------|-----------|---------------|
|                           | Neutral                   | Dual      | Paired    | Non-Breakaway |
| 30-S1212                  | 30-S1212N                 | 30-S1212D | 30-S1212P |               |
| 30-S1222                  | 30-S1222N                 |           |           |               |
| 30-S2212                  | 30-S2212N                 |           |           | 30-S2212T     |
| 30-S2222                  | 30-S2222N                 | 30-S2222D | 30-S2222P |               |

### EXAMPLES:

1. An in-line fused breakaway kit with crimp terminations, one 10 AWG wire on the line side and one 10 AWG wire on the load side is ordered as a 30-C1616.
2. An in-line non-fused (i.e., neutral) breakaway kit with set screw terminations, one 6 AWG wire on the line side and one 10 AWG wire on the load side is ordered as a 30-S1212N.
3. A Y-tap fused breakaway kit with crimp terminations, two 6 AWG wires on the line side and one 10 AWG wire on the load side is ordered as a 30-C2216.
4. A Dual in-line breakaway (hot/hot ganged together) with crimp terminations, one 10 AWG wire on each line side and one 10 AWG wire on each load side is ordered as a 30-C1616D.
5. A Paired in-line breakaway (hot/neutral ganged together) with set screw terminations, one 6 AWG wire on each line side and one 10 AWG wire on

Note: For combination 2 wire line (2-14 AWG Set Screw) and 1 wire load (6-14 AWG Crimp), use 30-B2216.



# IDEAL<sup>®</sup> - BUCHANAN SLK<sup>™</sup> DISCONNECT FUSE KITS

## AVAILABLE PART NUMBERS

| Catalog Number | Description   |
|----------------|---|
| 30-S1212       | In-Line Breakaway, set screw; fused; 1 wire line side, 2-14 AWG; 1 wire load side, 2-14 AWG                           |
| 30-S1222       | In-Line Breakaway, set screw; fused; 1 wire line side, 2-14 AWG; 2 wire load side, 2-14 AWG                           |
| 30-S1212N      | In-Line Breakaway, set screw; non-fused; 1 wire line side, 2-14 AWG; 1 wire load side, 2-14 AWG                       |
| 30-S1222N      | In-Line Breakaway, set screw; non-fused; 1 wire line side, 2-14 AWG; 2 wire load side, 2-14 AWG                       |
| 30-C1212       | In-Line Breakaway, crimp; fused; 1 wire line side, 2-4 AWG; 1 wire load side, 2-4 AWG                                 |
| 30-C1216       | In-Line Breakaway, crimp; fused; 1 wire line side, 2-4 AWG; 1 wire load side, 6-14 AWG                                |
| 30-C1616       | In-Line Breakaway, crimp; fused; 1 wire line side, 6-14 AWG; 1 wire load side, 6-14 AWG                               |
| 30-C1222       | In-Line Breakaway, crimp; fused; 1 wire line side, 2-4 AWG; 2 wire load side, 6-8 AWG                                 |
| 30-C1226       | In-Line Breakaway, crimp; fused; 1 wire line side, 2-4 AWG; 2 wire load side, 10-14 AWG                               |
| 30-C1622       | In-Line Breakaway, crimp; fused; 1 wire line side, 6-14 AWG; 2 wire load side, 6-8 AWG                                |
| 30-C1626       | In-Line Breakaway, crimp; fused; 1 wire line side, 6-14 AWG; 2 wire load side, 10-14 AWG                              |
| 30-C1212N      | In-Line Breakaway, crimp; non-fused; 1 wire line side, 2-4 AWG; 1 wire load side, 2-4 AWG                             |
| 30-C1216N      | In-Line Breakaway, crimp; non-fused; 1 wire line side, 2-4 AWG; 1 wire load side, 6-14 AWG                            |
| 30-C1616N      | In-Line Breakaway, crimp; non-fused; 1 wire line side, 6-14 AWG; 1 wire load side, 6-14 AWG                           |
| 30-C1222N      | In-Line Breakaway, crimp; non-fused; 1 wire line side, 2-4 AWG; 2 wire load side, 6-8 AWG                             |
| 30-C1226N      | In-Line Breakaway, crimp; non-fused; 1 wire line side, 2-4 AWG; 2 wire load side, 10-14 AWG                           |
| 30-C1622N      | In-Line Breakaway, crimp; non-fused; 1 wire line side, 6-14 AWG; 2 wire load side, 6-8 AWG                            |
| 30-C1626N      | In-Line Breakaway, crimp; non-fused; 1 wire line side, 6-14 AWG; 2 wire load side, 10-14 AWG                          |
| 30-S2212       | Y-Tap Breakaway, set screw; fused; 2 wire line side, 2-14 AWG; 1 wire load side, 2-14 AWG                             |
| 30-S2222       | Y-Tap Breakaway, set screw; fused; 2 wire line side, 2-14 AWG; 2 wire load side, 2-14 AWG                             |
| 30-S2212N      | Y-Tap Breakaway, set screw; non-fused; 2 wire line side, 2-14 AWG; 1 wire load side, 2-14 AWG                         |
| 30-S2222N      | Y-Tap Breakaway, set screw; non-fused; 2 wire line side, 2-14 AWG; 2 wire load side, 2-14 AWG                         |
| 30-C2012       | Y-Tap Breakaway, crimp; fused; 2 wire line side, 2-4 AWG; 1 wire load side, 2-4 AWG                                   |
| 30-C2016       | Y-Tap Breakaway, crimp; fused; 2 wire line side, 2-4 AWG; 1 wire load side, 6-14 AWG                                  |
| 30-C2216       | Y-Tap Breakaway, crimp; fused; 2 wire line side, 6-8 AWG; 1 wire load side, 6-14 AWG                                  |
| 30-C2616       | Y-Tap Breakaway, crimp; fused; 2 wire line side, 10-14 AWG; 1 wire load side, 6-14 AWG                                |
| 30-C2022       | Y-Tap Breakaway, crimp; fused; 2 wire line side, 2-4 AWG; 2 wire load side, 6-8 AWG                                   |
| 30-C2026       | Y-Tap Breakaway, crimp; fused; 2 wire line side, 2-4 AWG; 2 wire load side, 10-14 AWG                                 |
| 30-C2222       | Y-Tap Breakaway, crimp; fused; 2 wire line side, 6-8 AWG; 2 wire load side, 6-8 AWG                                   |
| 30-C2226       | Y-Tap Breakaway, crimp; fused; 2 wire line side, 6-8 AWG; 2 wire load side, 10-14 AWG                                 |
| 30-C2626       | Y-Tap Breakaway, crimp; fused; 2 wire line side, 10-14 AWG; 2 wire load side, 10-14 AWG                               |
| 30-C2012N      | Y-Tap Breakaway, crimp; non-fused; 2 wire line side, 2-4 AWG; 1 wire load side, 2-4 AWG                               |
| 30-C2016N      | Y-Tap Breakaway, crimp; non-fused; 2 wire line side, 2-4 AWG; 1 wire load side, 6-14 AWG                              |
| 30-C2216N      | Y-Tap Breakaway, crimp; non-fused; 2 wire line side, 6-8 AWG; 1 wire load side, 6-14 AWG                              |
| 30-C2616N      | Y-Tap Breakaway, crimp; non-fused; 2 wire line side, 10-14 AWG; 1 wire load side, 6-14 AWG                            |
| 30-C2022N      | Y-Tap Breakaway, crimp; non-fused; 2 wire line side, 2-4 AWG; 2 wire load side, 6-8 AWG                               |
| 30-C2026N      | Y-Tap Breakaway, crimp; non-fused; 2 wire line side, 2-4 AWG; 2 wire load side, 10-14 AWG                             |
| 30-C2222N      | Y-Tap Breakaway, crimp; non-fused; 2 wire line side, 6-8 AWG; 2 wire load side, 6-8 AWG                               |
| 30-C2226N      | Y-Tap Breakaway, crimp; non-fused; 2 wire line side, 6-8 AWG; 2 wire load side, 10-14 AWG                             |
| 30-C2626N      | Y-Tap Breakaway, crimp; non-fused; 2 wire line side, 10-14 AWG; 2 wire load side, 10-14 AWG                           |
| 30-S2212T      | Y-Tap Non-Breakaway, set screw; fused; 2 wire line side, 2-14 AWG; 1 wire load side, 2-14 AWG                         |
| 30-C2012T      | Y-Tap Non-Breakaway, crimp; fused; 2 wire line side, 2-4 AWG; 1 wire load side, 2-4 AWG                               |
| 30-C2016T      | Y-Tap Non-Breakaway, crimp; fused; 2 wire line side, 2-4 AWG; 1 wire load side, 6-14 AWG                              |
| 30-C2216T      | Y-Tap Non-Breakaway, crimp; fused; 2 wire line side, 6-8 AWG; 1 wire load side, 6-14 AWG                              |
| 30-C2616T      | Y-Tap Non-Breakaway, crimp; fused; 2 wire line side, 10-14 AWG; 1 wire load side, 6-14 AWG                            |
| 30-S1212D      | Dual In-Line Breakaway, set screw; fused; 1 wire line side, 2-14 AWG; 1 wire load side, 2-14 AWG                      |
| 30-C1212D      | Dual In-Line Breakaway, crimp; fused; 1 wire line side, 2-4 AWG; 1 wire load side, 2-4 AWG                            |
| 30-C1216D      | Dual In-Line Breakaway, crimp; fused; 1 wire line side, 2-4 AWG; 1 wire load side, 6-14 AWG                           |
| 30-C1616D      | Dual In-Line Breakaway, crimp; fused; 1 wire line side, 6-14 AWG; 1 wire load side, 6-14 AWG                          |
| 30-S2222D      | Dual Y-Tap Breakaway, set screw; fused; 2 wire line side, 2-14 AWG; 2 wire load side, 2-14 AWG                        |
| 30-C2022D      | Dual Y-Tap Breakaway, crimp; fused; 2 wire line side, 2-4 AWG; 2 wire load side, 6-8 AWG                              |
| 30-C2026D      | Dual Y-Tap Breakaway, crimp; fused; 2 wire line side, 2-4 AWG; 2 wire load side, 10-14 AWG                            |
| 30-C2222D      | Dual Y-Tap Breakaway, crimp; fused; 2 wire line side, 6-8 AWG; 2 wire load side, 6-8 AWG                              |
| 30-C2226D      | Dual Y-Tap Breakaway, crimp; fused; 2 wire line side, 6-8 AWG; 2 wire load side, 10-14 AWG                            |
| 30-C2626D      | Dual Y-Tap Breakaway, crimp; fused; 2 wire line side, 10-14 AWG; 2 wire load side, 10-14 AWG                          |
| 30-S1212P      | Paired In-Line Breakaway, set screw; one fused, one non-fused; 1 wire line side, 2-14 AWG; 1 wire load side, 2-14 AWG |
| 30-C1212P      | Paired In-Line Breakaway, crimp; one fused, one non-fused; 1 wire line side, 2-4 AWG; 1 wire load side, 2-4 AWG       |
| 30-C1216P      | Paired In-Line Breakaway, crimp; one fused, one non-fused; 1 wire line side, 2-4 AWG; 1 wire load side, 6-14 AWG      |
| 30-C1616P      | Paired In-Line Breakaway, crimp; one fused, one non-fused; 1 wire line side, 6-14 AWG; 1 wire load side, 6-14 AWG     |
| 30-S2222P      | Paired Y-Tap Breakaway, set screw; one fused, one non-fused; 2 wire line side, 2-14 AWG; 2 wire load side, 2-14 AWG   |
| 30-C2022P      | Paired Y-Tap Breakaway, crimp; one fused, one non-fused; 2 wire line side, 2-4 AWG; 2 wire load side, 6-8 AWG         |
| 30-C2026P      | Paired Y-Tap Breakaway, crimp; one fused, one non-fused; 2 wire line side, 2-4 AWG; 2 wire load side, 10-14 AWG       |
| 30-C2222P      | Paired Y-Tap Breakaway, crimp; one fused, one non-fused; 2 wire line side, 6-8 AWG; 2 wire load side, 6-8 AWG         |
| 30-C2226P      | Paired Y-Tap Breakaway, crimp; one fused, one non-fused; 2 wire line side, 6-8 AWG; 2 wire load side, 10-14 AWG       |
| 30-C2626P      | Paired Y-Tap Breakaway, crimp; one fused, one non-fused; 2 wire line side, 10-14 AWG; 2 wire load side, 10-14 AWG     |
| 30-HS2         | Fuseholder only, non-breakaway, set screw; fused; 1 wire line side, 2-14 AWG; 1 wire load side, 2-14 AWG              |
| 30-HC2         | Fuseholder only, non-breakaway, crimp; fused; 1 wire line side, 2-4 AWG; 1 wire load side, 6-14 AWG                   |
| 30-HC6         | Fuseholder only, non-breakaway, crimp; fused; 1 wire line side, 6-14 AWG; 1 wire load side, 6-14 AWG                  |
| 30-B2216       | Combination Y-Tap Breakaway, fused; 2 wire line side, set screw, 2-14 AWG; 1 wire load side, crimp, 6-14 AWG          |

IDEAL INDUSTRIES, INC.