

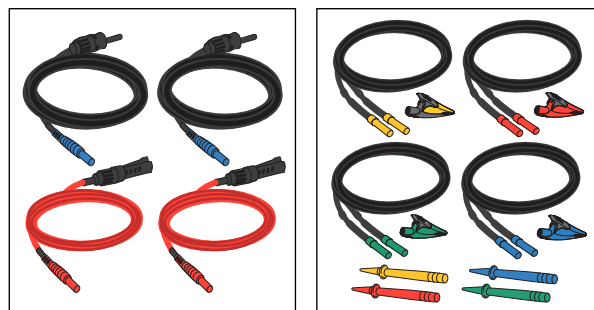

FLUKE

SMFT-1000 Multifunction PV Analyzer

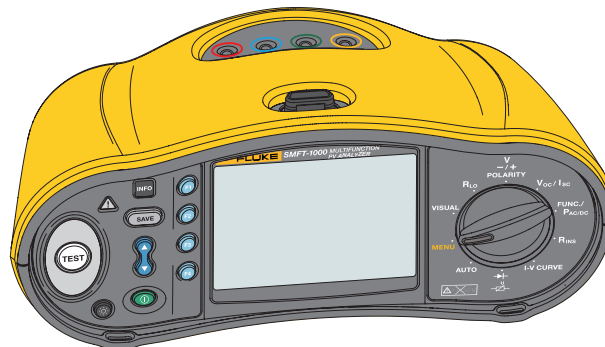

PN 5292395 9/2022
©2022 Fluke Corporation. All Rights Reserved.

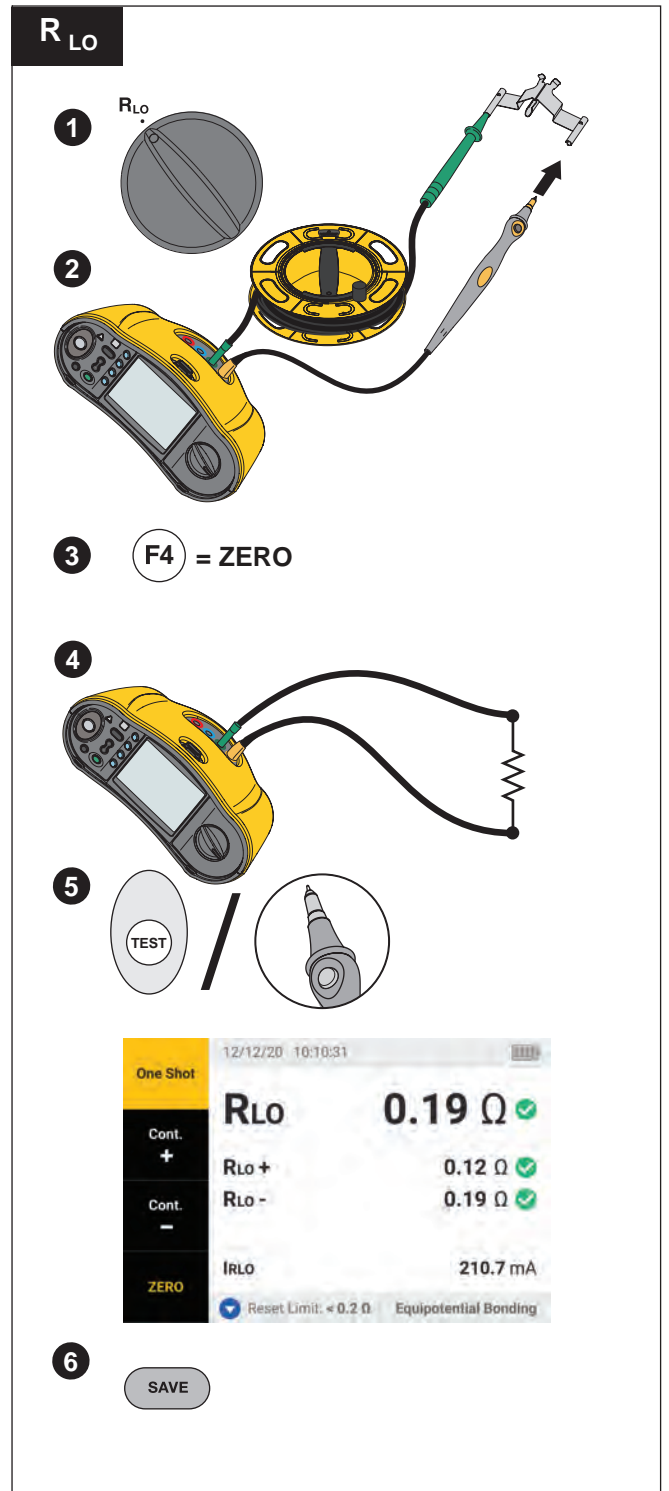
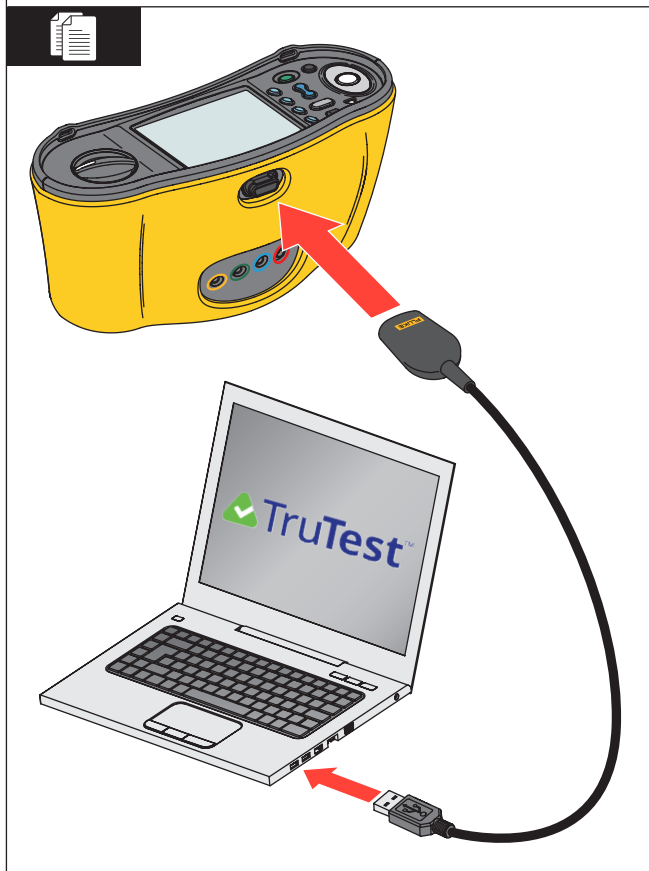
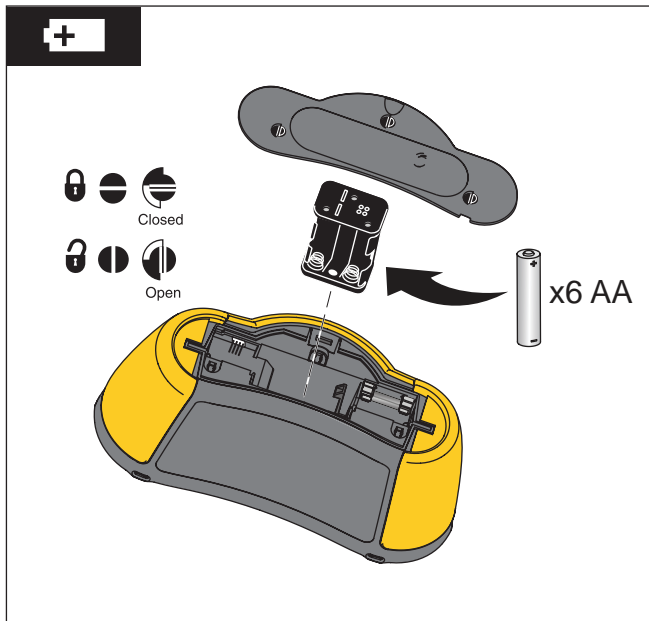

V -/+ POLARITY

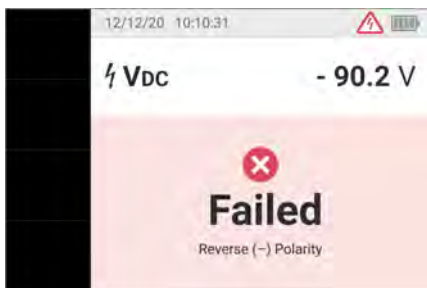
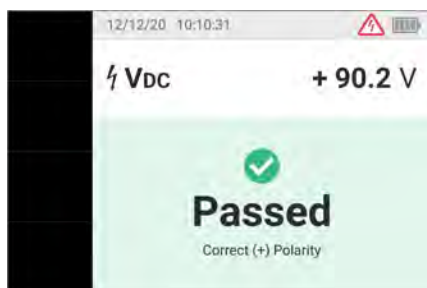
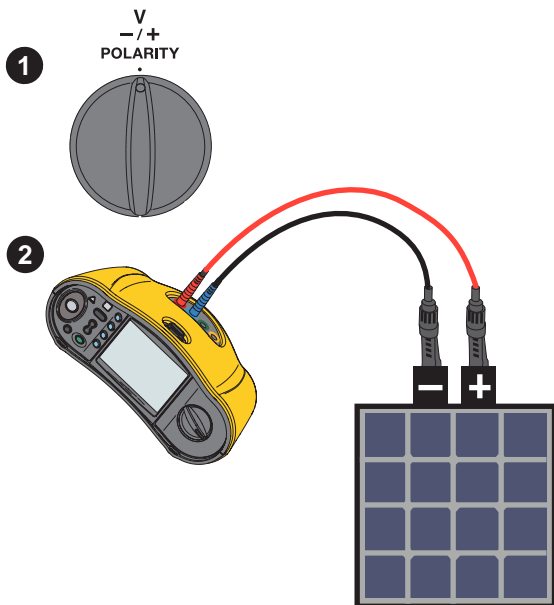

V_{OC}/I_{SC}

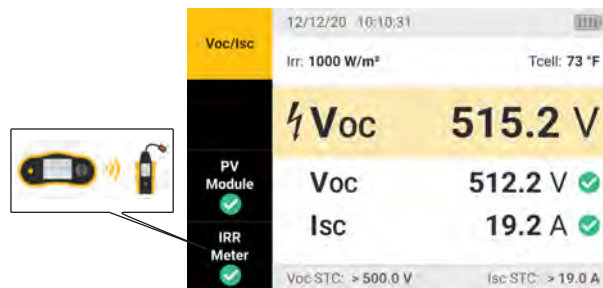
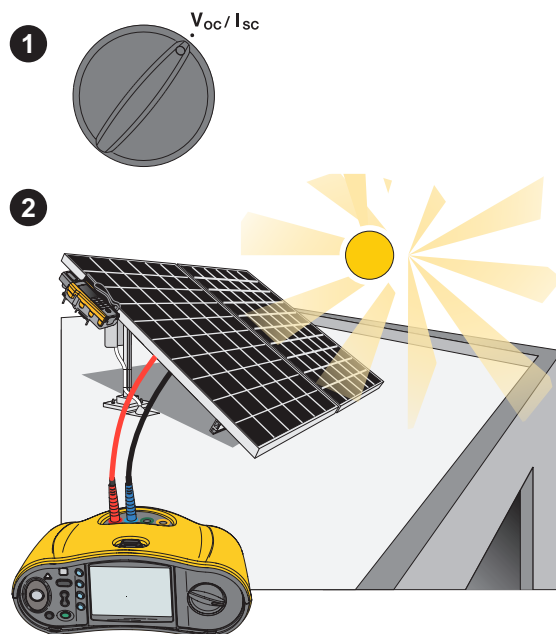

FUNC./P_{AC/DC}

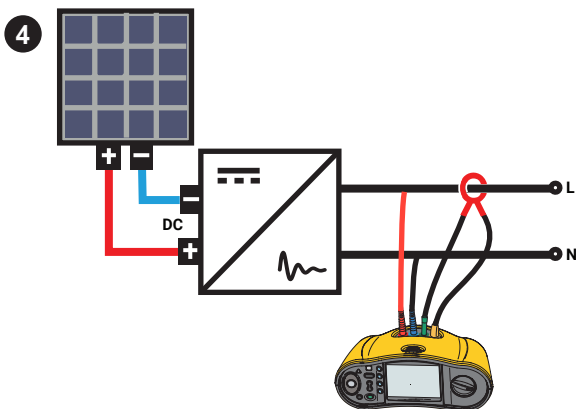
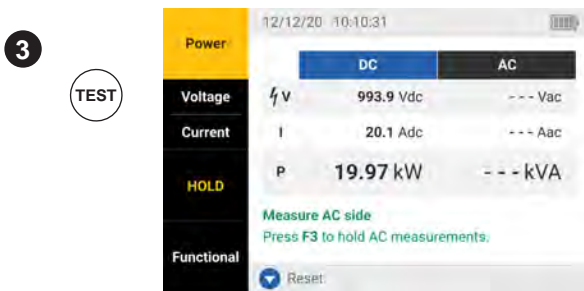
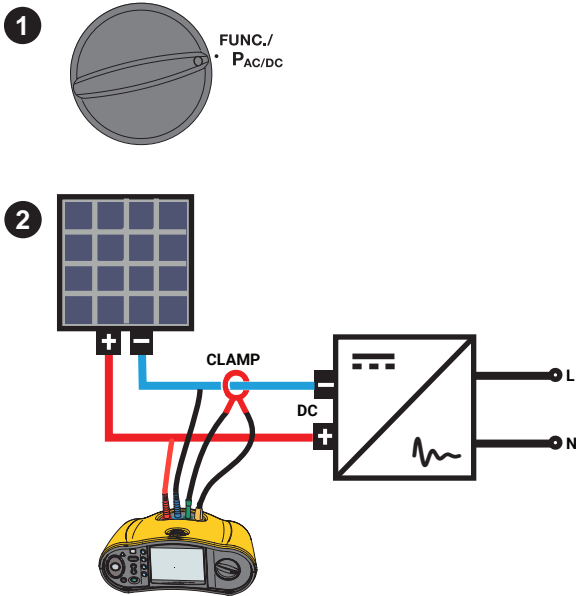

R_{INS}

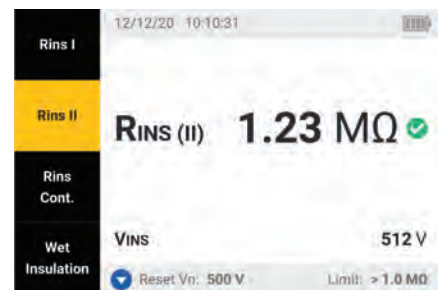
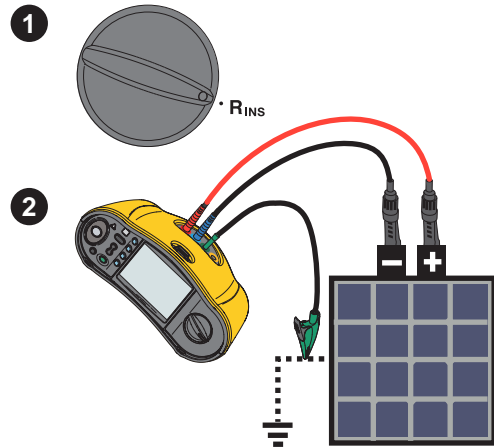

3. Press the SAVE button.

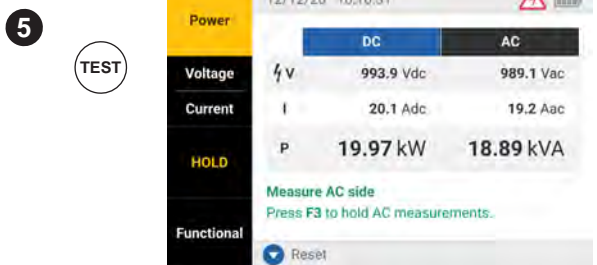

6. Press F3. Efficiency Factor: 94.5 %

7. Press the SAVE button.

I-V

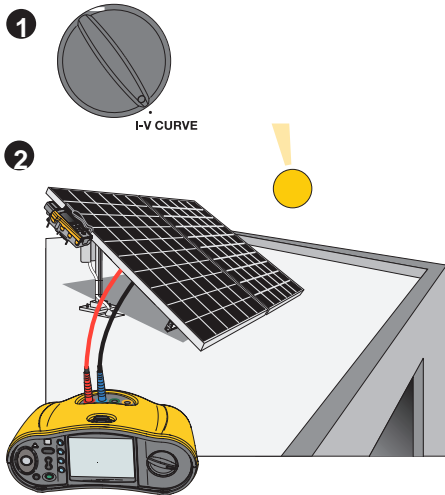
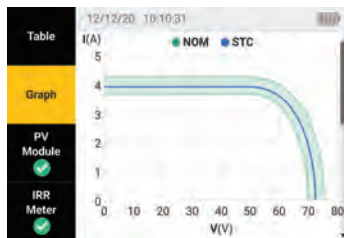

Table 12/12/20 10:10:31

Ir: 1000 W/m² Tcell: 73 °F

	NOM	STC
Voc	44.4 V	40.2 V
Isc	5.4 A	5.1 A
Vmpp	50.2 V	50.1 V
Impp	6.4 A	6.1 A
Pmpp	175 W	170 W
FF	95 %	92 %

Pass Criteria: 5%



SAVE

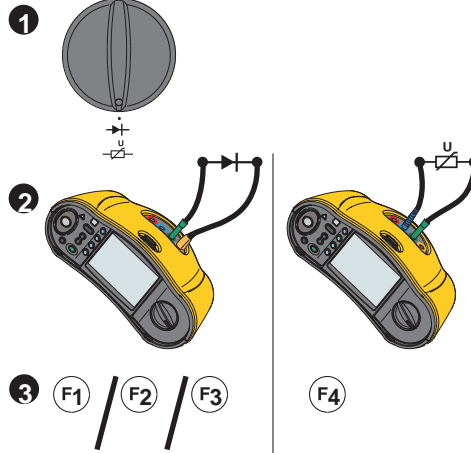

TES

Table 12/12/20 10:10:31

Bypass Diode

Blocking Diode

Diode

SPD

V_{DIODE} 1.11 V

I₀ 210.2 mA

SHUNT: 0.5 V = 1.65 V

SAVE

IRR2-

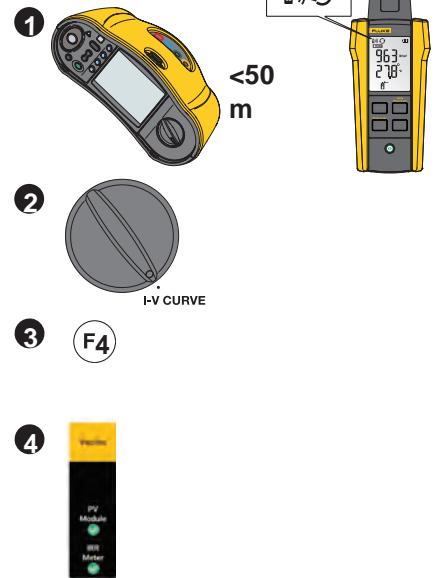

Select 12/12/20 10:10:31

Memory

13 Saved Measurements

Client/Site

New Site A

Test Engineer

Note Assigned

Device Settings

Help